

**From Gainesville:**

Take GA Hwy 53 through Oakwood to Braselton.

**From Braselton:**

Cross over I-85 and continue toward Winder. Once in the Winder City Limits, GA Hwy 53 becomes North Broad Street. Pass the Winder Community Hospital and continue for approximately 1.5 miles. Our office is on the right at the corner of North Broad Street and Jerome Street.

**From Atlanta/Hamilton Mill Area:**

Take I-85 N to Exit 126/ GA Hwy 211. Turn right onto GA Hwy 211 and continue approximately 7 miles to the intersection of Broad Street. The Barrow County Courthouse is at this intersection on the right. Turn left and continue approximately 0.5 mile. Our office is on the left at the corner of North Broad Street and Jerome Street.

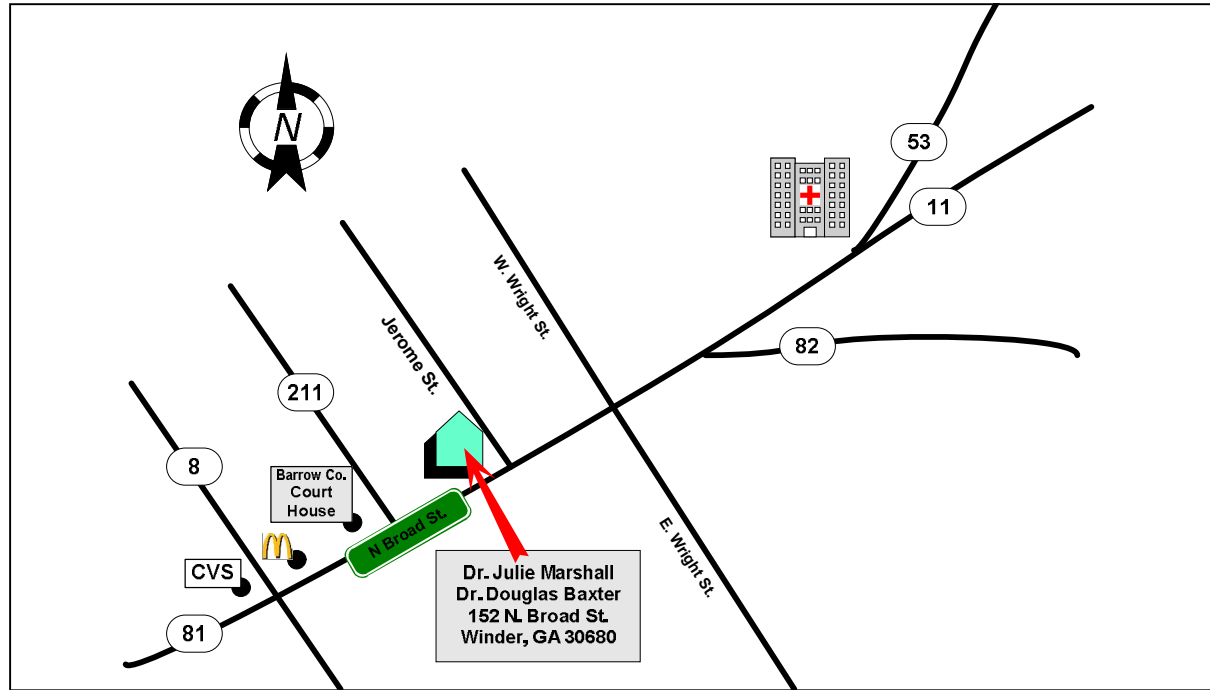

**From Loganville:**

Take GA Hwy 81 out of Loganville toward Winder. Cross over GA Hwy 316 and continue toward Winder. GA Hwy 81 will turn into Broad Street. Cross over GA Hwy 8 / May Street (McDonald's on the left). Continue for approximately 0.75 mile. Our office is on the left at the corner of North Broad Street and Jerome Street.

**From Athens:**

Take GA Hwy 316 toward Atlanta. Turn right onto GA Hwy 81 toward Winder, which will turn into Broad Street. Cross over GA Hwy 8 / May Street (McDonald's on the left). Continue for approximately 0.75 mile. Our office is on the left at the corner of North Broad Street and Jerome Street.

**From Jefferson:**

Take Hwy 11 into Winder. Once in the Winder City Limits, GA Hwy 11 becomes North Broad Street. Pass the Winder Community Hospital and continue for approximately 1.5 miles. Our office is on the right at the corner of North Broad Street and Jerome Street.

**Julie B. Marshall, D.M.D.**

**Douglas P. Baxter, D.M.D.**

152 North Broad Street

Winder, Georgia 30680

Phone (770) 867-4175

Fax (770) 868-1564

[www.baxterandmarshall.com](http://www.baxterandmarshall.com)